

# T-MAX™ 506/657

## Quick Operator's Guide

### ⚠ WARNING

This procedure is for water-base paints and flushing fluids. For solvent-base paints and flushing fluids (i.e. mineral spirits), you must read Fire and Explosion Hazard in the Operating Instructions. \* check the Graco operations manual delivered with the unit for more details.

### SETUP

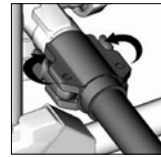
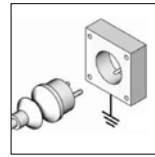
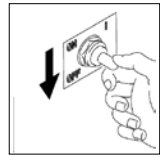
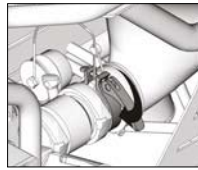
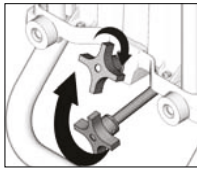
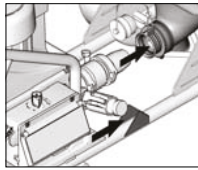

Connect pump module to hopper cart.

Turn pump control off (0).  
Connect power cord.

Remove pump plug.  
Connect material hose to pump outlet.

### STARTUP

Spray **without Air** < .25 mm



Fill material hopper with pre-mixed texture material.



Add water if thinning is required. Mix thoroughly.



Turn pressure control knob until a steady stream flows from material hose.

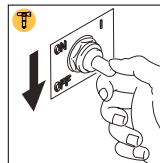

Turn pump OFF.

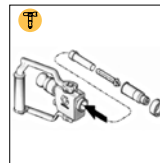

Install filter and tip extension.

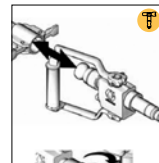

Connect applicator to material hose.

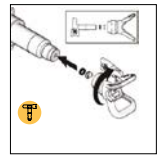

Screw tip assembly onto applicator

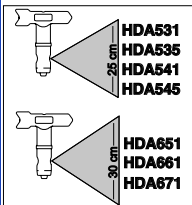

Use different tip size for different flow

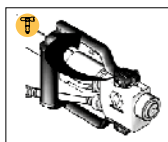

Turn applicator OFF, Turn ON/OFF switch to ON



Turn pressure control to maximum. To spray, aim applicator with a distance of 0,5 m to the wall and open applicator.



To clean a tip clog, turn applicator OFF, turn Tip 180° to Clean position, aim in waste area, turn applicator ON, when clog clears, turn applicator OFF and tip in spray position.

### PRESSURE RELIEF PROCESS

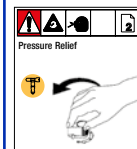

Turn pressure control off (0).

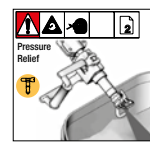

Point applicator into hopper. Turn applicator ON.

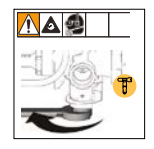

Loosen nut on bottom of pump two to three turns to relieve pressure

### STARTUP

Spray **with Air** <= 1.5 mm



Fill material hopper with mixed texture material.



Place material hose in Hopper turn ON/OFF switch to ON Turn control in the "green" segment, allow material to circulate 30 sec.

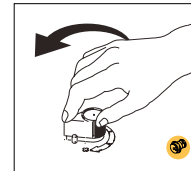
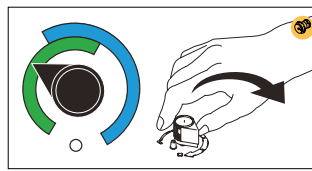

Turn pump control to shut pump off

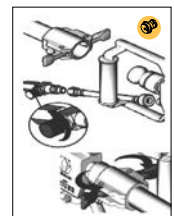

Screw air hose and valve to applicator. Connect material hose to gun kit

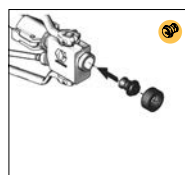

Turn applicator valve OFF. Install air nozzle.

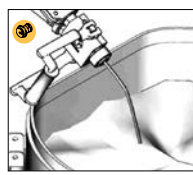

Hold applicator over material hopper and turn applicator ON.

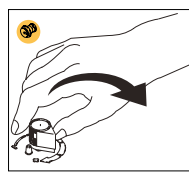

Turn air compressor ON. Turn pump control in the "green" area, until desired material rate is achieved.

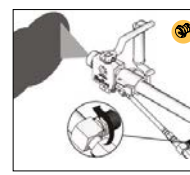

Regulate the air valve to get a good atomization.

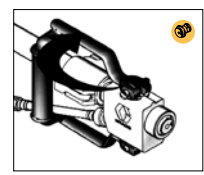

To stop spraying, turn applicator OFF

# CLEANUP

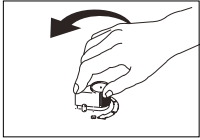

Turn pump control counter clockwise, to shut pump off.  
Close applicator after pressure release, close air valve

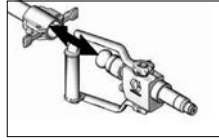

Shut OFF air compressor if spraying with air.  
Remove applicator from material hose.  
Clean applicator.



Turn pump control clockwise and pump unused texture material from material hopper and hose.



Scrape material remaining in hopper into pump to be pumped from sprayer.

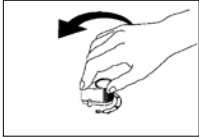

Rotate pump control to (0) to shut pump off.



Remove drain plug from Hopper  
Clean hopper with water, brush and sponge, install drain plug, fill hopper 1/3 with clear water.

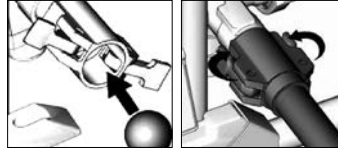

Insert wet cleaning ball into pump.  
Connect material hose to pump outlet.

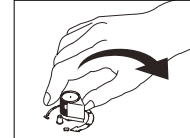

Rotate pump control clockwise to start pump.

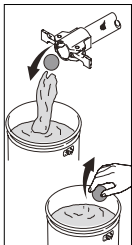

Run pump until cleaning ball exits material hose. Save cleaning ball. Repeat it till the water that comes out is clear.

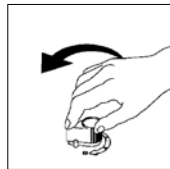

Rotate pump control to (0) to shut pump off.

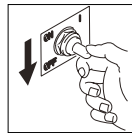

ON/OFF switch to OFF

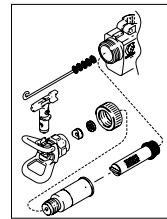
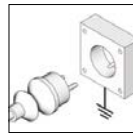

Clean applicator, spray tips and guard with brush.

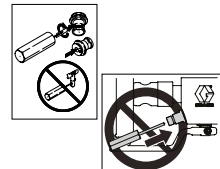

Clean hardened material from applicator nozzles with air nozzle cleaner.

# CHOOSE THE RIGHT TIP (HDA-XXX)

	XTRA LIGHT	LIGHT	MEDIUM	HEAVY
	HDA531	HDA541	HDA651	HDA671
	HDA535	HDA545	HDA661	-

	VERY FINE - 3MM	FINE - 4MM	MEDIUM - 6MM	MEDIUM HEAVY - 8MM	HEAVY - 10MM
	248888	248524	248525	248526	248527